

EH-30854-000

SHT 1.1

NOTES:

- 1 A POSITIVE GOING VOLTAGE AT TERMINAL 2, RELATIVE TO TERMINAL 1, CAUSES A DECREASE IN PRESSURE AT THE SOUND OUTLET.
- 2 LOCATED FROM TWO SURFACES FOR CUSTOMER CONVENIENCE. ONLY APPLICABLE FROM ONE SURFACE, NOT TO BE USED TOGETHER. HORIZONTAL LOCATION FOR TERMINALS CENTERED TO $\pm 0,17$ [.007].

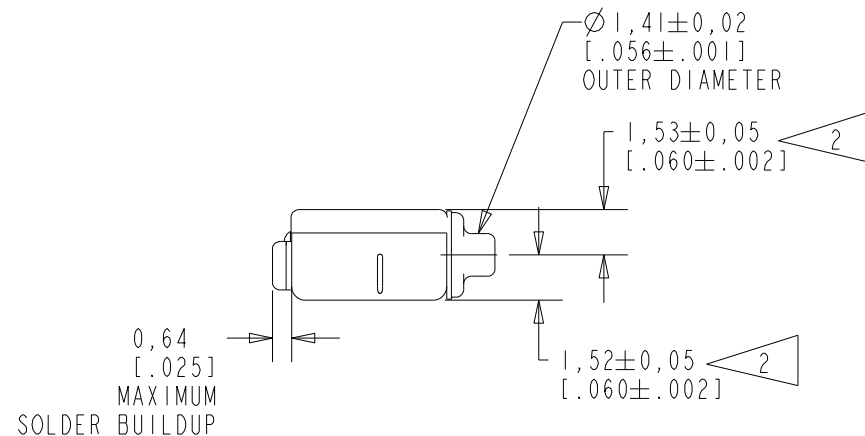
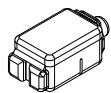
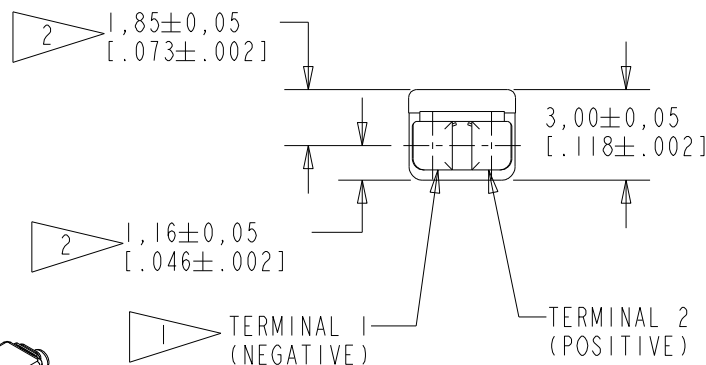
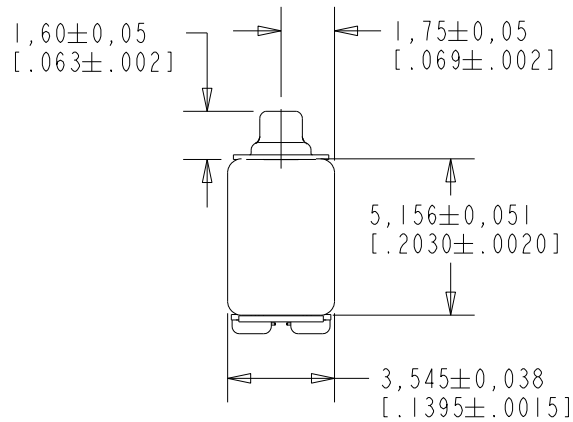

SCALE 2:1
NOMINAL WEIGHT
.23 GRAMS

DIMENSIONS IN MILLIMETERS [INCHES]

KNOWLES CORPORATION

| Revision | C.O. # | Implementation Date | RELEASE LEVEL | REVISION |
|----------|-----------|---------------------|---------------|----------|
| B | PI0000990 | 11-25-16 | Active | B |
| A | CI0110546 | 11-27-09 | | |

| | | | |
|----------------------|--------------|-------------|----------------|
| SCALE: 4:1 | | DR. BY: SDZ | DATE: 11-27-09 |
| DO NOT SCALE DRAWING | | | |
| TITLE: RECEIVER | EH-30854-000 | GJP | 11-8-09 |
| OUTLINE DRAWING | SHT 1.1 | GJP | 12-1-0 |

THE EH-30854-000 IS A TYPE III DAMPED MAGNETIC BALANCED ARMATURE RECEIVER WITH HIGH MAGNET CHARGE.

TYPE III DAMPING

EH-30854-000
SHEET 2.1

CONSTANT VOLTAGE DRIVE CONDITIONS

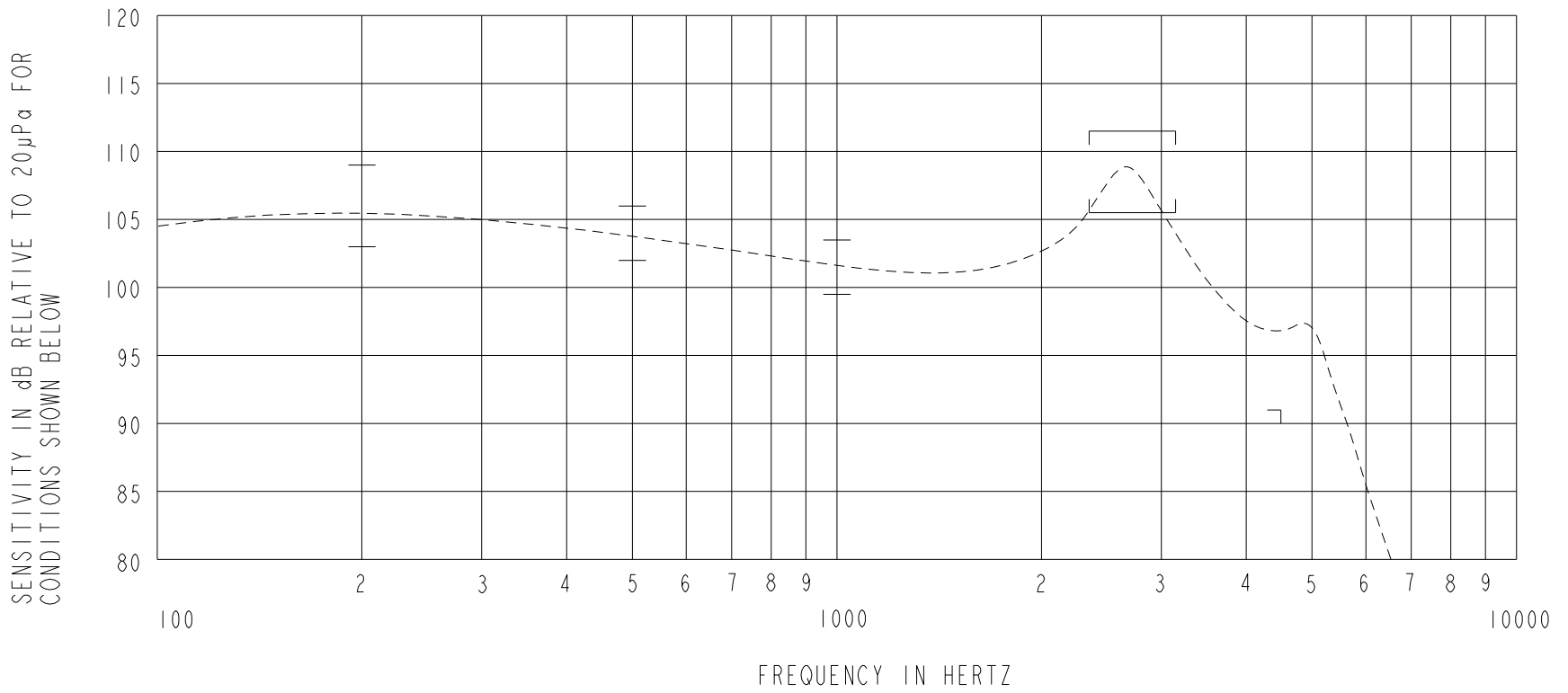

ACOUSTICAL

SENSITIVITY
DEVICE WILL PRODUCE THE SPL LISTED BELOW UNDER TEST CONDITIONS DESCRIBED IN TABLE 3.
NOMINAL SENSITIVITY AT 1kHz IS dB RELATIVE TO 20µPa. ALL OTHER VALUES
IN dB RELATIVE TO THE SENSITIVITY AT 1kHz.

| FREQUENCY (Hz) | MINIMUM | NOMINAL | MAXIMUM |
|----------------|---------|---------|---------|
| 200 | +1.0 | +4.0 | +7.0 |
| 500 | +0.5 | +2.5 | +4.5 |
| 1000 | -2.0 | 101.5 | +2.0 |
| 2350 - 3150 | +4.0 | +7.0 | +10.0 |
| 4500 | -10.5 | --- | --- |

PORT LOCATION: 12S

TABLE 1

TOTAL HARMONIC DISTORTION
DEVICE WILL NOT EXCEED TOTAL HARMONIC DISTORTION LEVELS LISTED BELOW.

| FREQUENCY (Hz) | AC DRIVE (V rms) | DC BIAS (V) | LIMIT (%) |
|----------------|------------------|-------------|-----------|
| 883 | 0.206 | 0 | 5 |
| 883 | 0.58 | 0 | 10 |
| 1325 | 0.206 | 0 | 5 |
| 1325 | 0.58 | 0 | 10 |

TABLE 2

TEST CONDITIONS

| | |
|------------------------|-----------------------------------------------------------------|
| NOMINAL SOURCE VOLTAGE | 0.206 V rms, 0 mA DC BIAS |
| SOURCE IMPEDANCE | <1 Ohm |
| TUBING | 10mm [.394"] LONG, 1mm [.039"] I.D. |
| COUPLER CAVITY | 2 CM ³ , SIMULATED ANSI S3.7 TYPE HA-3 (IEC 60318-5) |

TABLE 3

ELECTRICAL

| | |
|--------------------|----------------|
| DC RESISTANCE | 52 Ohms ± 10% |
| IMPEDANCE @ 500 Hz | 90 Ohms ± 15% |
| IMPEDANCE @ 1kHz | 152 Ohms ± 15% |

TABLE 4

ISOLATION: CASE WILL BE ELECTRICALLY ISOLATED FROM THE COIL CIRCUIT.

| Revision | C.O. # | Implementation Date | RELEASE LEVEL | REVISION |
|--------------------------------------------------------------------------------------------------------------------------------------------------------------------------------------------------------------|-----------|---------------------|---------------|----------|
| B | PI0000990 | 11-25-16 | Active | B |
| A | CI0110546 | 11-27-09 | | |
| WHEN TEST LIMITS ARE USED TO ESTABLISH INCOMING INSPECTION ACCEPTANCE/REJECTION CRITERIA, CORRELATION OF TEST EQUIPMENT WITH KNOWLES IS ALSO REQUIRED FOR ELIMINATION OF EQUIPMENT AND TEST METHOD VARIATION | | | DR. BY | DATE |
| KNOWLES CORPORATION TITLE: RECEIVER PERFORMANCE SPECIFICATION | | | SDZ | 11-27-09 |
| | | | GJP | 11-8-09 |
| EH-30854-000 SHT 2.1 | | | APP. BY | DATE |
| | | | GJP | 12-1-0 |